

OCTAFORM[®] STEM WALLS

RAISED FOUNDATIONS / PONY WALLS

A long-term investment is built on a strong foundation and sturdy walls. Since 1997, Octaform's industry-leading design has allowed for versatility, energy efficiency, and enhanced structural integrity.

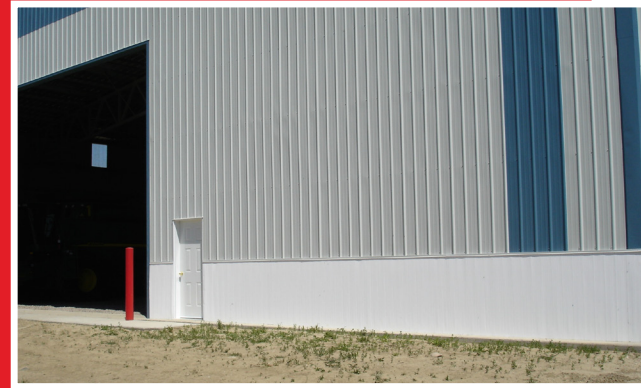

BUILD IT TO LAST



- 1 **REBAR** Uses standard rebar as specified by your engineer.
- 2 **OPTIONAL INSULATION** Thermal mass of concrete, airtightness, added EPS insulation provides excellent R-values.
- 3 **PVC PANEL** Outside panel protects the concrete and rebar from harsh chemicals and corrosive environments. Octaform PVC meets the strict sanitation standard set by the CFIA.
- 4 **WALL THICKNESS** Connectors are available for walls between 4-24" thick.
- 5 **CONCRETE** Compatible with standard concrete formulations. The system requires vibrating as specified and is poured in 4' lifts.

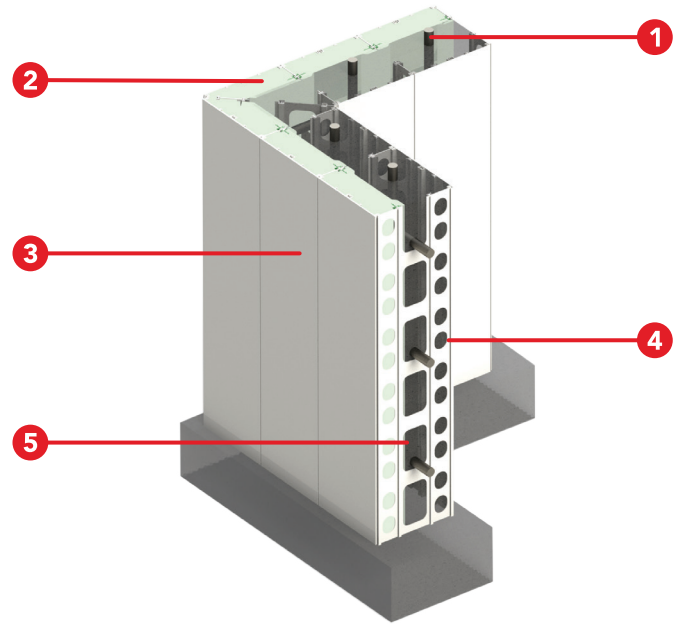

INNOVATING SINCE 1997

CONCRETE, BUT BETTER

Choose Octaform and, in one step, form watertight concrete walls, of any height & thickness, without the burden of heavy equipment or secondary trades.

Extruded from industry-leading, durable PVC, Octaform creates a barrier between your wall and the elements that can harm it.



NEW ZEALAND REPRESENTATIVES AND INSTALLERS:

PROVARKO LTD

Raymond Dobbe

0274 322 282

raymond@provarko.co.nz

Jason Frost

021 741 658

jason@provarko.co.nz

Provarko

RENEWABLE ENERGY

WWW.PROVARKO.CO.NZ

