



OCTAFORM[®] DAIRY FACILITIES

Whether you are breaking ground or retrofitting, Octaform can help create a bright, durable & hygienic environment for your cows. Extruded from food-grade PVC, Octaform walls are easy to clean, look great and can even lower energy costs.

BUILD IT TO LAST



BARN



ROTARIES



ROBOTIC PARLORS



MANURE TANKS

- 1 **REBAR** Uses standard rebar as specified by your engineer.
- 2 **OPTIONAL INSULATION** Thermal mass of concrete, airtightness, added EPS insulation provides excellent R-values.
- 3 **PVC PANEL** Outside panel protects the concrete and rebar from harsh chemicals and corrosive environments. Octaform PVC meets the strict sanitation standard set by the CFIA.
- 4 **WALL THICKNESS** Connectors are available for walls between 4" to 24" thick.
- 5 **CONCRETE** Compatible with standard concrete formulations. The system requires vibrating as specified and is poured in 4' lifts.

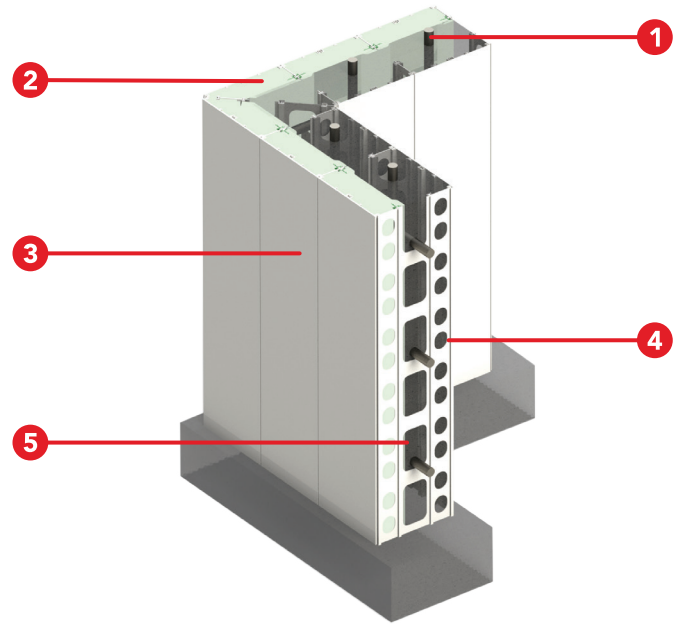

INNOVATING SINCE 1997

OCTAFORM® QUICKLINER INDUSTRIAL^{HD}

TIME FOR A REFRESH?

Protect and extend the life of your investment for years to come with durable, hygienic, food-grade PVC panels!



NEW ZEALAND REPRESENTATIVES AND INSTALLERS:

PROVARKO LTD

Raymond Dobbe

0274 322 282

raymond@provarko.co.nz

Jason Frost

021 741 658

jason@provarko.co.nz

Provarko

RENEWABLE ENERGY

WWW.PROVARKO.CO.NZ

